

TYPE-DESCRIPTION

DEGASSING- AND AERATIONSYSTEM "TYP SS" FOR IBC'S AND DRUMS

Technical Data:

Material: sintered oleo- and hydrophobe ultra highmolecular HDPE

Chemical Resistanze: against all hazardous liquids

GASFLOW:

Typ SS1 > 17 l per hour at ΔP 8 kPa

Typ SS40 > 60 l per hour at ΔP 8 kPa

Typ SS100 > 130 l per hour at ΔP 8 kPa
(for hotfillings IBC)

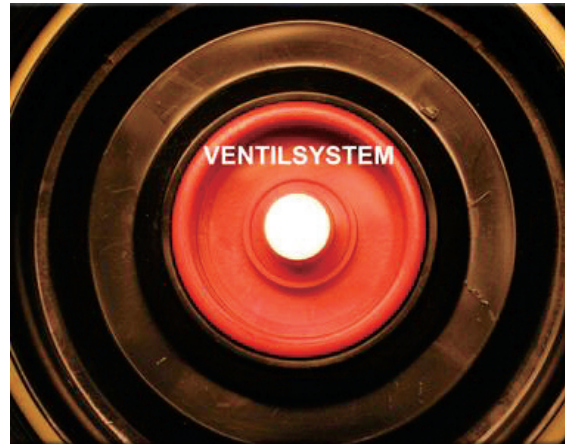

Reduction of gasflow due to contact with the filling-liquid is excluded by the OLEOPHOBIC and HYDROPHOBIC effect of the valve.

The valve can be mounted in ALL CONVENTIONAL degasification-screwcaps for drums and IBC's.

GASFLOW-CHART

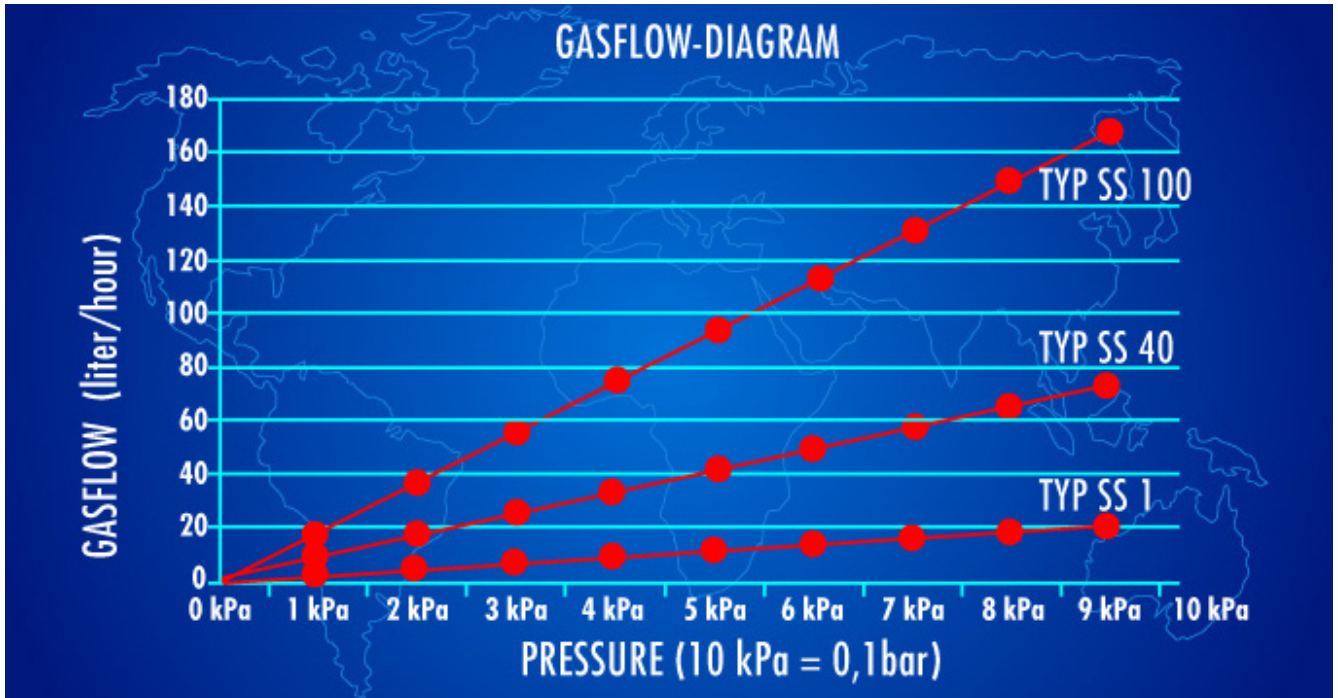

DIMENSIONS IN MM

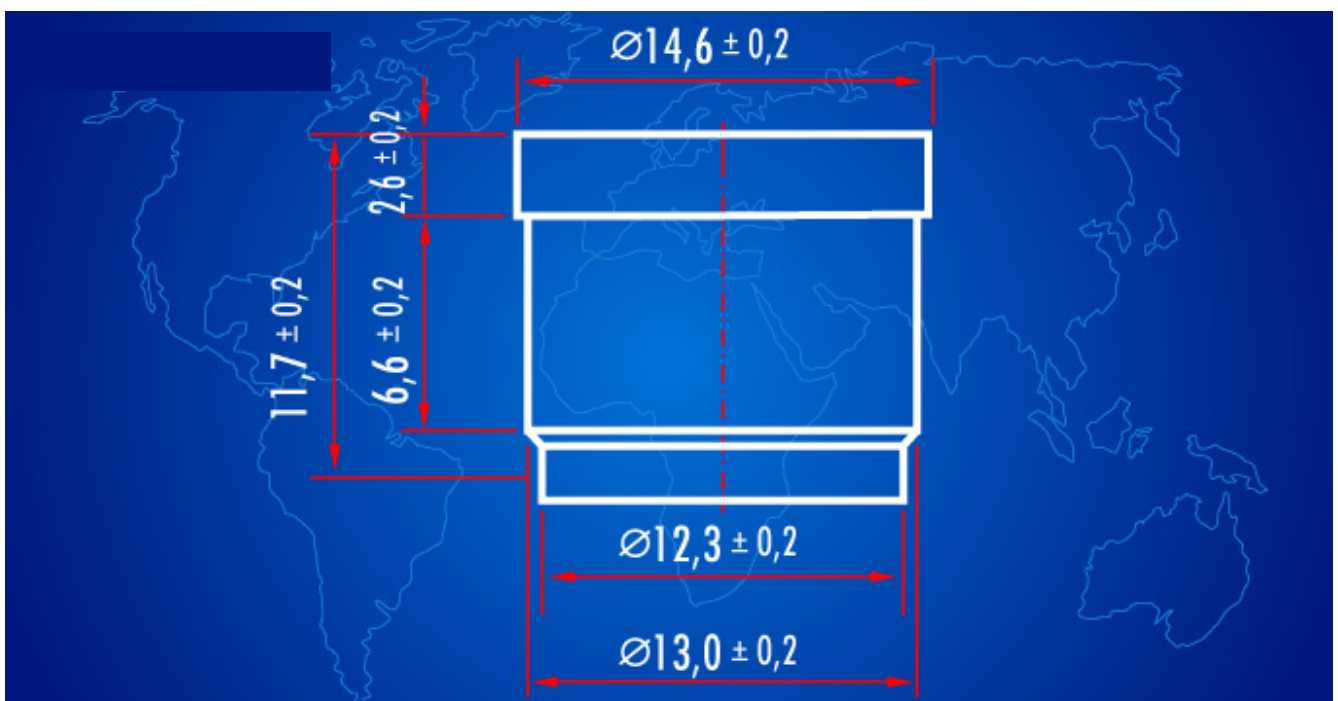

VALVE-SEAT DIMENSIONS IN MM

